

# ifcOWL status update

2016 buildingSMART International Standards Summit  
Rotterdam, The Netherlands  
Technical Room

Pieter Pauwels, Ghent University

12 April 2016

16:00 – 18:00

LDWG



**STANDARDISATION!**

# ifcOWL Proposal as presented in BS ISM Singapore 2015

## 1. Officialisation of Linked Data Working Group

**Remained unchanged,  
so this is still an open request!!**

## 2. Presentation of ifcOWL ontology as a recommended standard (to be further evaluated):

- ifcOWL ontology
- HTML documentation
- Proposed Recommendation

## 3. Requirements for hosting the ifcOWL online

# HTML documentation pages

← → ↻ ifcowl.openbimstandards.org/IFC4\_ADD1/index.html ☆ ☰

## ifcOWL ontology (IFC4\_ADD1)

**IRI:**

[http://ifcowl.openbimstandards.org/IFC4\\_ADD1](http://ifcowl.openbimstandards.org/IFC4_ADD1)

**Date:**

January 22, 2016

**This version:**

1.3

**Previous version:**

December 11, 2015: [http://www.openbimstandards.org/IFC4\\_ADD1/index.html](http://www.openbimstandards.org/IFC4_ADD1/index.html)

**Latest version:**

January 22, 2016: [http://ifcowl.openbimstandards.org/IFC4\\_ADD1/index.html](http://ifcowl.openbimstandards.org/IFC4_ADD1/index.html)

**Authors:**

Pieter Pauwels ([pipauwel.pauwels@ugent.be](mailto:pipauwel.pauwels@ugent.be))  
Walter Terkaj ([walter.terkaj@itia.cnr.it](mailto:walter.terkaj@itia.cnr.it))

**Contributors:**

Jakob Beetz ([j.beetz@tue.nl](mailto:j.beetz@tue.nl))  
María Poveda Villalón ([mpoveda@fi.upm.es](mailto:mpoveda@fi.upm.es))  
Aleksandra Sojic ([aleksandra.sojic@itia.cnr.it](mailto:aleksandra.sojic@itia.cnr.it))

**Ontology source:**

[TTL\\_OWL](#)

**Imported Ontologies:**

<https://w3id.org/list>  
<https://w3id.org/express>

**License:**

This work is licensed under a <http://creativecommons.org/licenses/by/3.0/> license.

## Abstract

This ifcOWL ontology is automatically generated from the EXPRESS schema 'IFC4\_ADD1' using the 'IFC-to-RDF' converter developed by Pieter Pauwels ([pipauwel.pauwels@ugent.be](mailto:pipauwel.pauwels@ugent.be)), based on the earlier versions from Jurki Orskari

# Status in the standards process

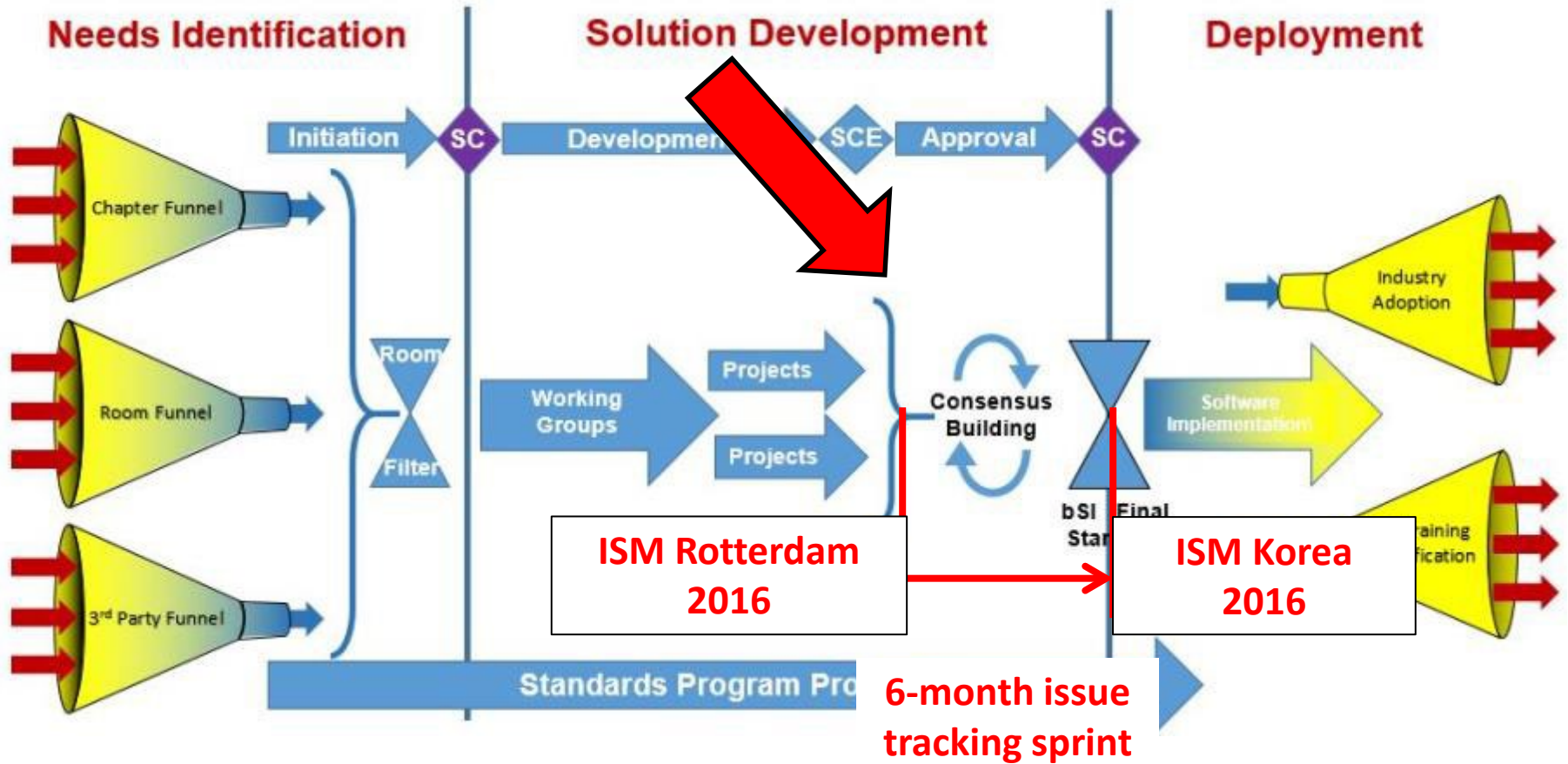

Cover page	1. Scope	5. Core data schemas	A. Computer interpretable listings	E. Examples
Contents	2. Normative references	6. Shared element data schemas	B. Alphabetical listings	F. Change logs
Foreword	3. Terms, definitions, and abbreviated terms	7. Domain specific data schemas	C. Inheritance listings	Bibliography
Introduction	4. Fundamental concepts and assumptions	8. Resource definition data schemas	D. Diagrams	Index

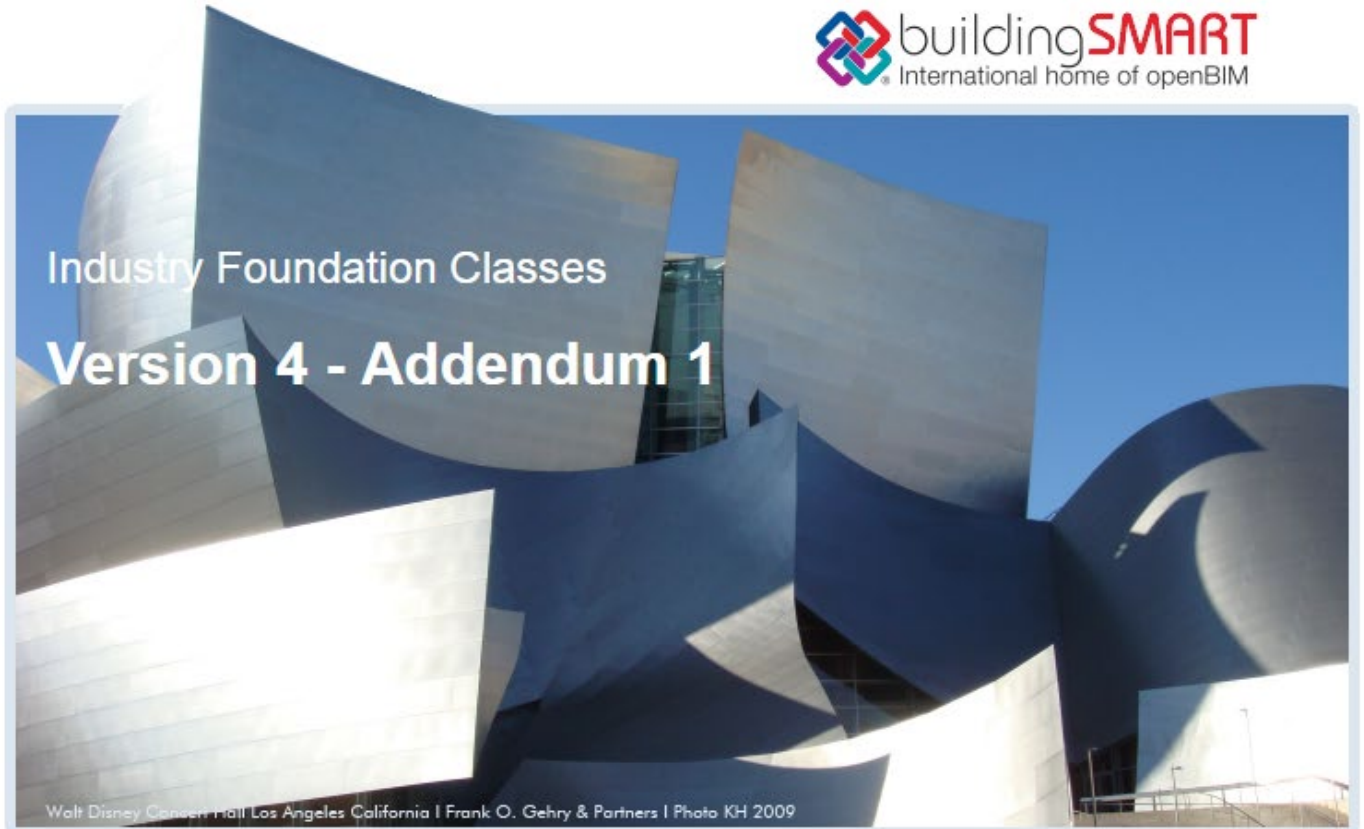

The specification has been developed in 1999-2015 by the [Model Support Group](#) - MSG - of buildingSMART International Ltd, and contributors under the coordination of

Thomas Liebich - MSG Leader  
Tim Chinn - MSG Deputy

© buildingSMART 1996-2014 - This document is owned and copyrighted by buildingSMART International Limited  
By using the IFC4 specification you agree to the following [copyright notice](#)

Implementation  
in IfcDoc

file:///C:/Users/generic/Desktop/testOutputIfcDoc/ifc4/index.htm

## IFC4 - Addendum 1 [Final Standard]

Cover	1. Scope	5. Core data schemas	A. Computer
Contents	2. Normative references	6. Shared element data schemas	B. Alphabetical lists
Foreword	3. Terms, definitions, and abbreviated terms	7. Domain specific data schemas	C. Inheritance listings
Introduction	4. Fundamental concepts and assumptions	8. Resource definition data	D. Diagrams

- 5.1.2.4 IfcPropertySetTemplateTypeEnum
- 5.1.2.5 IfcSimplePropertyTemplateTypeEnum
- 5.1.2.6 IfcDefinitionSelect
- 5.1.2.7 IfcProcessSelect
- 5.1.2.8 IfcProductSelect
- 5.1.2.9 IfcPropertySetDefinitionSelect
- 5.1.2.10 IfcResourceSelect
- 5.1.3 Entities
- 5.1.3.1 IfcActor
- 5.1.3.2 IfcComplexPropertyTemplate
- 5.1.3.3 IfcContext
- 5.1.3.4 IfcControl
- 5.1.3.5 IfcGroup
- 5.1.3.6 IfcObject
- 5.1.3.7 IfcObjectDefinition
- 5.1.3.8 IfcPreDefinedPropertySet
- 5.1.3.9 IfcProcess
- 5.1.3.10 IfcProduct
- 5.1.3.11 IfcProject
- 5.1.3.12 IfcProjectLibrary
- 5.1.3.13 IfcPropertyDefinition
- 5.1.3.14 IfcPropertySet
- 5.1.3.15 IfcPropertySetDefinition
- 5.1.3.16 IfcPropertySetTemplate
- 5.1.3.17 IfcPropertyTemplate
- 5.1.3.18 IfcPropertyTemplateDefinition
- 5.1.3.19 IfcProxy

### ▼ XSD Specification

```
<xs:simpleType name="IfcPropertySetTemplateTypeEnum">  
  <xs:restriction base="xs:string">  
    <xs:enumeration value="pset_typeddrivenonly"/>  
    <xs:enumeration value="pset_typeddrivenoverride"/>  
    <xs:enumeration value="pset_occurrencedriven"/>  
    <xs:enumeration value="pset_performancedriven"/>  
    <xs:enumeration value="qto_typeddrivenonly"/>  
    <xs:enumeration value="qto_typeddrivenoverride"/>  
    <xs:enumeration value="qto_occurrencedriven"/>  
    <xs:enumeration value="notdefined"/>  
  </xs:restriction>  
</xs:simpleType>
```

### ▶ EXPRESS Specification

### ▼ OWL Specification

```
ifc:IfcPropertySetTemplateTypeEnum  
rdf:type owl:Class ;  
owl:equivalentClass  
 [  
   rdf:type owl:Class ;  
   owl:oneOf  
   (  
     ifc:PSET_TYPEDDRIVENONLY  
     ifc:PSET_TYPEDDRIVENOVERRIDE
```

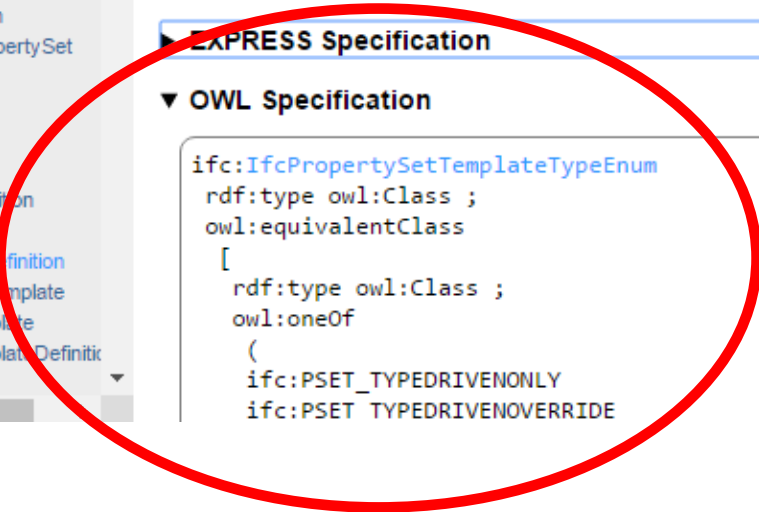



[Cover page](#)  
[Contents](#)  
[Foreword](#)  
[Introduction](#)

1. [Scope](#)  
 2. [Normative references](#)  
 3. [Terms, definitions, and abbreviated terms](#)  
 4. [Fundamental concepts and assumptions](#)

5. [Core data schemas](#)  
 6. [Shared element data schemas](#)  
 7. [Domain specific data schemas](#)  
 8. [Resource definition data schemas](#)

A. [Computer interpretable listings](#)  
 B. [Alphabetical listings](#)  
 C. [Inheritance listings](#)  
 D. [Diagrams](#)

E. [Examples](#)  
 F. [Change logs](#)  
[Bibliography](#)  
[Index](#)

## E.2 [Basic geometric shape](#)

E.2.1 [CSG primitive](#)  
 E.2.2 [Extruded solid](#)  
 E.2.3 [Surface model](#)  
 E.2.4 [Brep model](#)  
 E.2.5 [Tessellated item](#)

E.3 [Advanced geometric shape](#)  
 E.3.1 [Bath CSG Solid](#)  
 E.3.2 [Cube advanced Brep](#)  
 E.3.3 [Basin advanced brep](#)  
 E.3.4 [Basin faceted brep](#)  
 E.3.5 [Basin tessellation](#)  
 E.4 [Tessellated shape](#)

E.4.1 [Beam straight I-shape tessellated](#)

E.4.2 [Beam curved I-shape tessellated](#)

E.4.3 [Column straight rectangle tessellation](#)

E.4.4 [Slab tessellated unique vertices](#)

E.5 [Tessellated shape with style](#)

E.5.1 [Tessellation with individual colors](#)

E.6 [Mapped geometric shape](#)

E.6.1 [Mapped shape without transformation](#)

E.6.2 [Mapped shape with transformation](#)

E.6.3 [Mapped shape with multiple items](#)

E.7 [Placements and GIS referencing](#)

E.7.1 [Grid placement](#)

E.8 [Building element standard case](#)

E.8.1 [Beam standard case](#)

E.8.2 [Beam extruded solid](#)

E.8.3 [Beam revolved solid](#)

E.8.4 [Column extruded solid](#)

E.8.5 [Slab standard case](#)

E.8.6 [Wall standard case](#)

E.9 [Building element elemented case](#)

## E.2.2 Extruded solid

Format	ASCII	HTML
<a href="#">IFC-SPF</a>	<a href="#">File</a>	<a href="#">Markup</a>

### View

[Common Use Definitions](#)

### Entity

[IfcShapeRepresentation](#)

[IfcExtrudedAreaSolid](#)

The block geometry can be expressed using the swept solid geometry model, expressing it as an extruded solid.

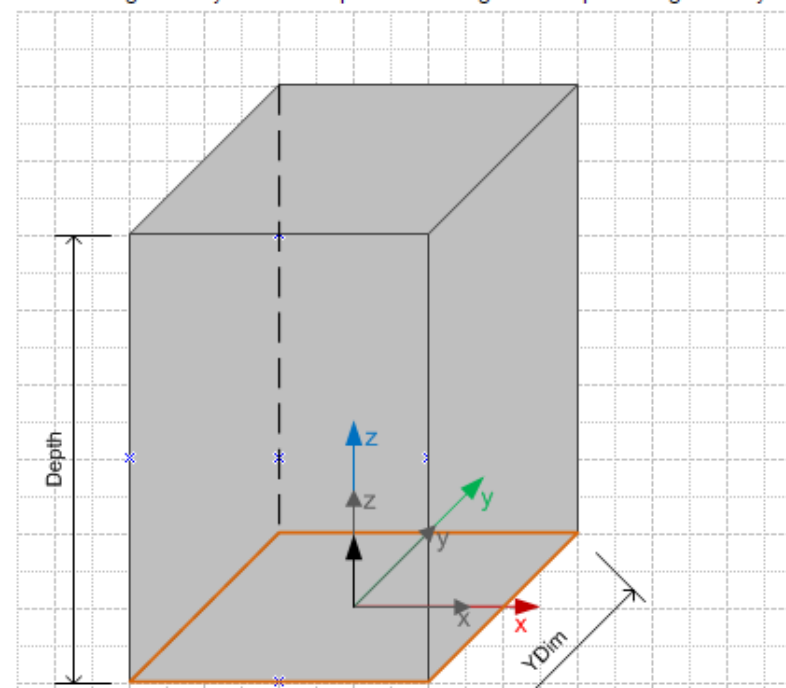



Implementation  
in IfcDoc

file:///C:/Users/generic/Desktop/testOutputIfcDoc/ifc4/index.htm

## IFC4 - Addendum 1 [Final Standard]

Cover	1. Scope	5. Core data schemas	A. Computer inter...
Contents	2. Normative references	6. Shared element data schemas	B. Alphabetical listings
Foreword	3. Terms, definitions, and abbreviated terms	7. Domain specific data schemas	C. Inheritance listings
Introduction	4. Fundamental concepts and assumptions	8. Resource definition data	D. Diagrams

- E.2 Basic geometric shape
  - E.2.1 CSG primitive
  - E.2.2 Extruded solid
  - E.2.3 Surface model
  - E.2.4 Brep model
  - E.2.5 Tessellated item
- E.3 Advanced geometric shape
  - E.3.1 Bath CSG Solid
  - E.3.2 Cube advanced Brep
  - E.3.3 Basin advanced brep
  - E.3.4 Basin faceted brep
  - E.3.5 Basin tessellation
- E.4 Tessellated shape
  - E.4.1 Beam straight I-shape tessellated
  - E.4.2 Beam curved I-shape tessellated
  - E.4.3 Column straight rectangle tessellation
  - E.4.4 Slab tessellated unique vertices
- E.5 Tessellated shape with style
  - E.5.1 Tessellation with individual colors
  - E.5.2 Tessellation with image texture
  - E.5.3 Tessellation with blob texture
  - E.5.4 Tessellation with pixel texture
- E.6 Mapped geometric shape
  - E.6.1 Mapped shape without transformation

### E.2.2 Extruded solid

Format	ASCII	HTML
XML	File	Markup
STEP	File	Markup
OWL	File	Markup

- View
- General Usage
- Design Transfer View

- Entity
- IfcShapeRepresentation
- IfcExtrudedAreaSolid

The block geometry can be expressed using the swept solid geometry model, expressing it as an extruded solid.

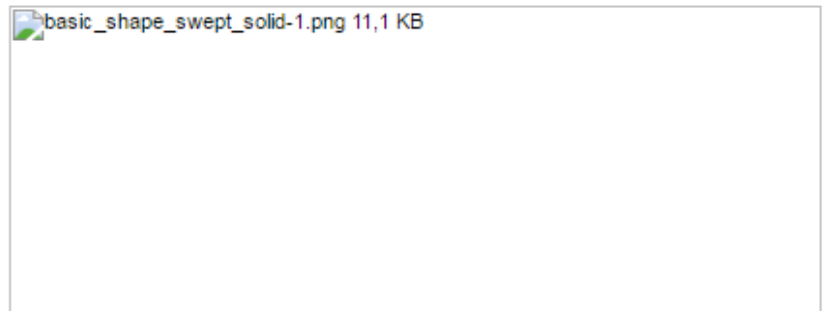

USABILITY?

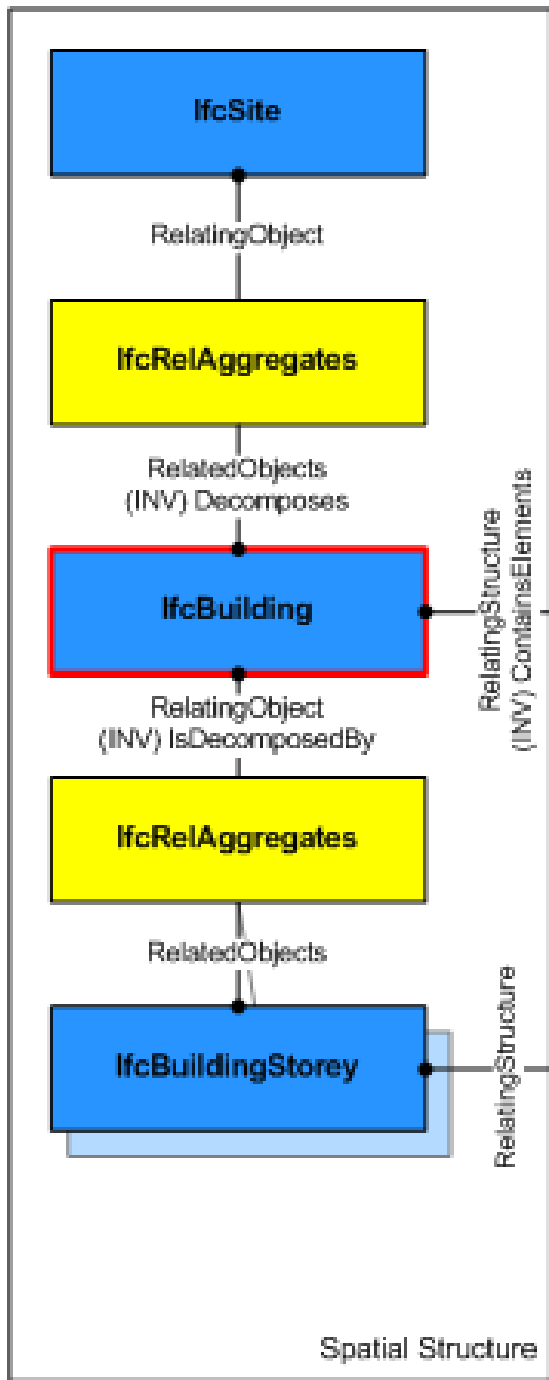

RelatingStructure (INV) ContainsElements

RelatingStructure

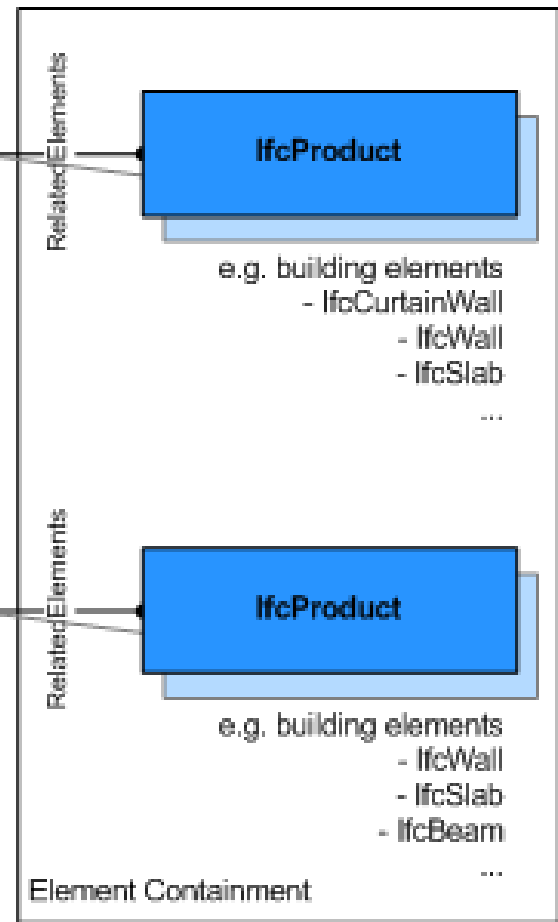

◆ inst:IfcProject\_94

ifcowl:relatedObjects\_IfcRelDecomposes

◆ inst:IfcSite\_2421

ifcowl:relatedObjects\_IfcRelDecomposes

◆ inst:IfcBuilding\_104

ifcowl:relatedObjects\_IfcRelDecomposes

◆ inst:IfcBuildingStorey\_119

◆ inst:IfcBuildingStorey\_113

ifcowl:relatedObjects\_IfcRelDecomposes

◆ inst:IfcSpace\_505

◆ inst:IfcSpace\_350

◆ inst:IfcSpace\_139

# ifcOWL

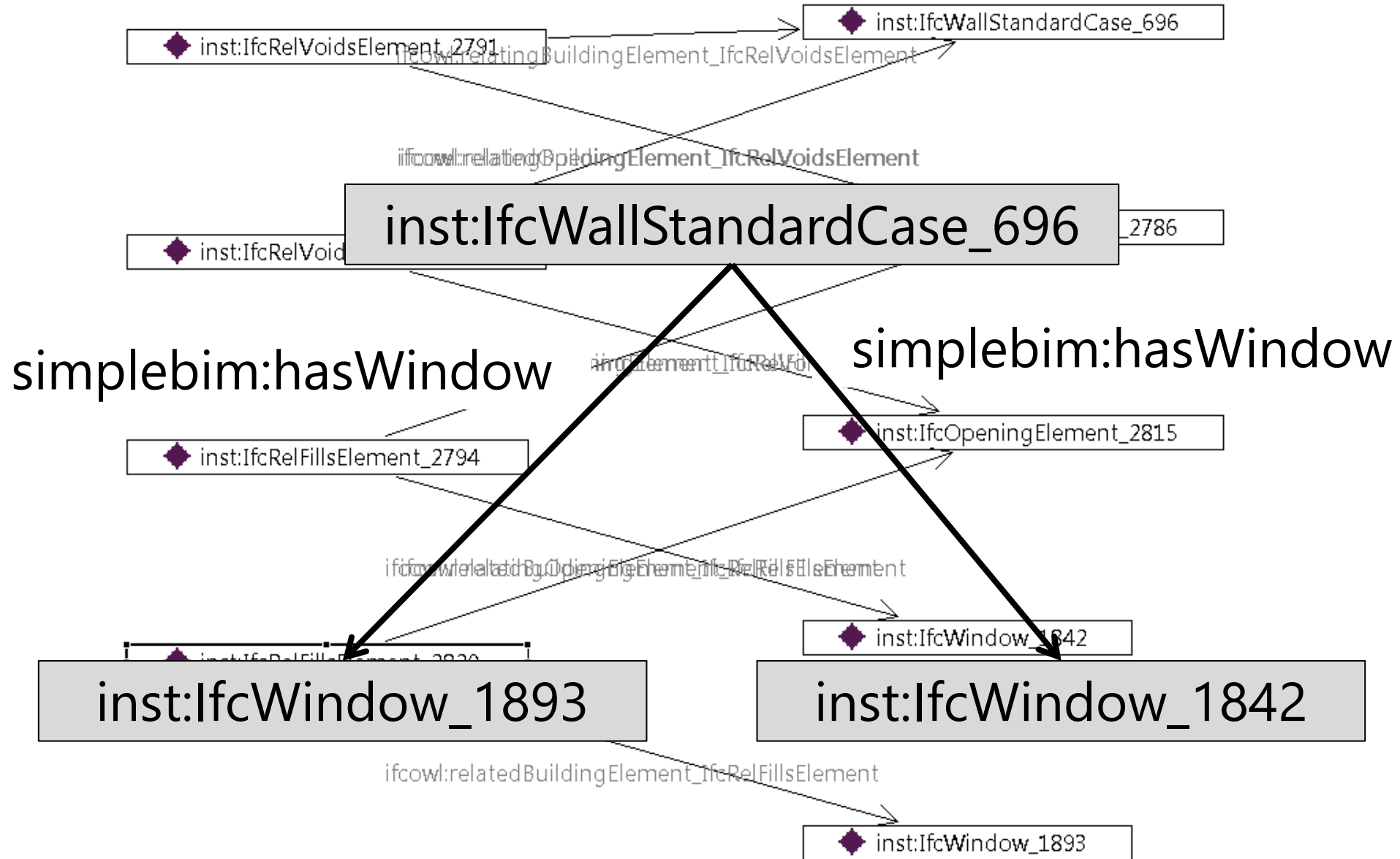

Converter?  
Rules?  
...?

ifcOWL

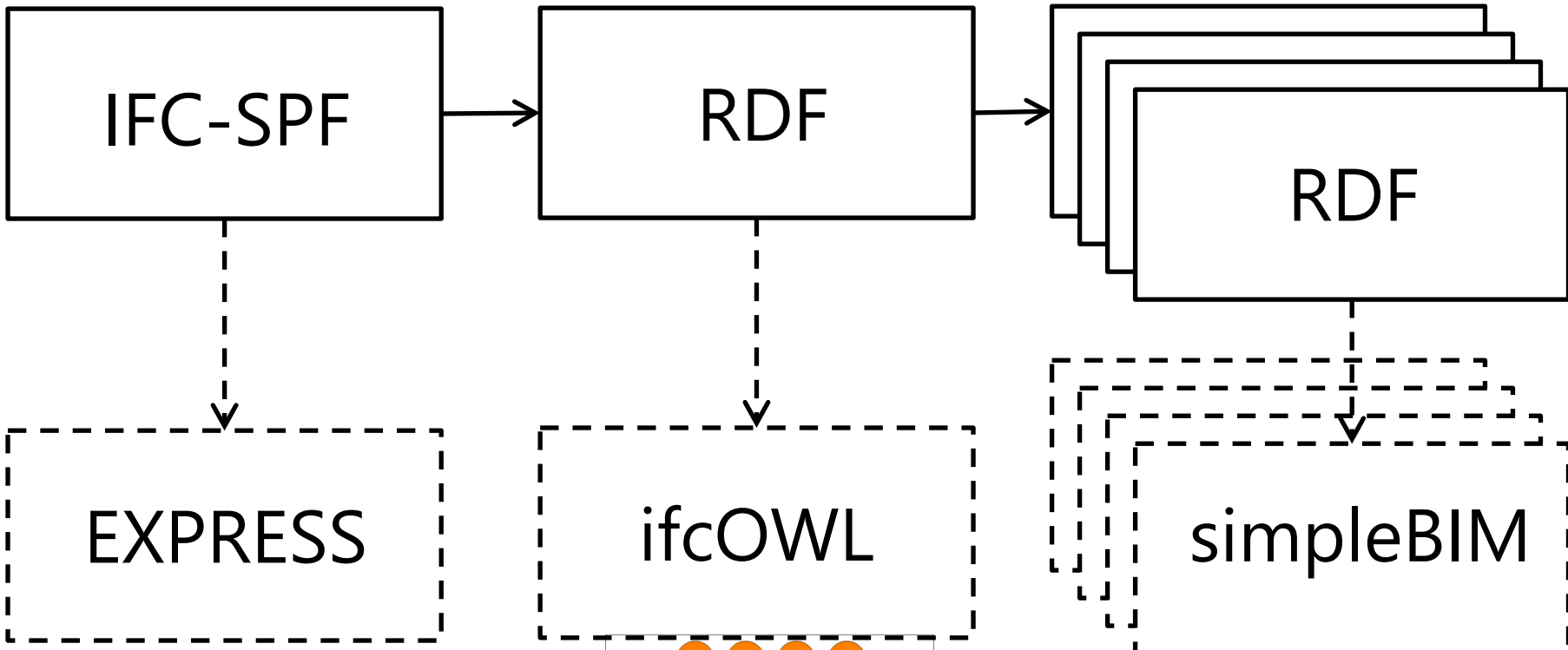

Converter?  
Rules?  
...?

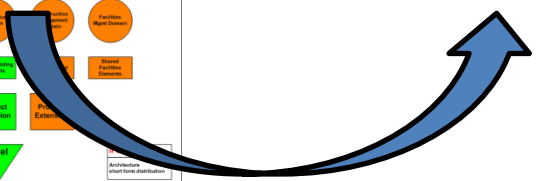

SMALL TEST



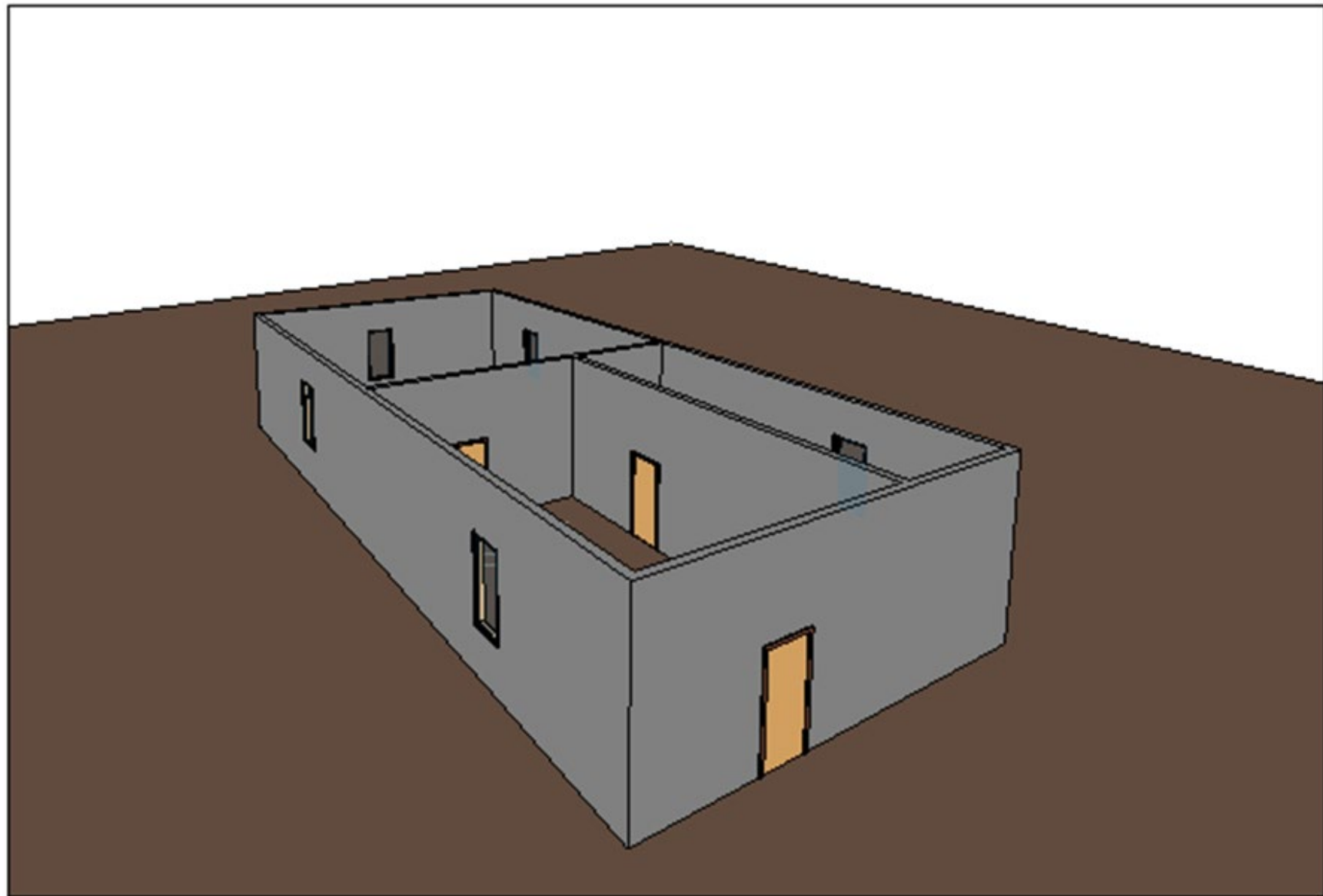

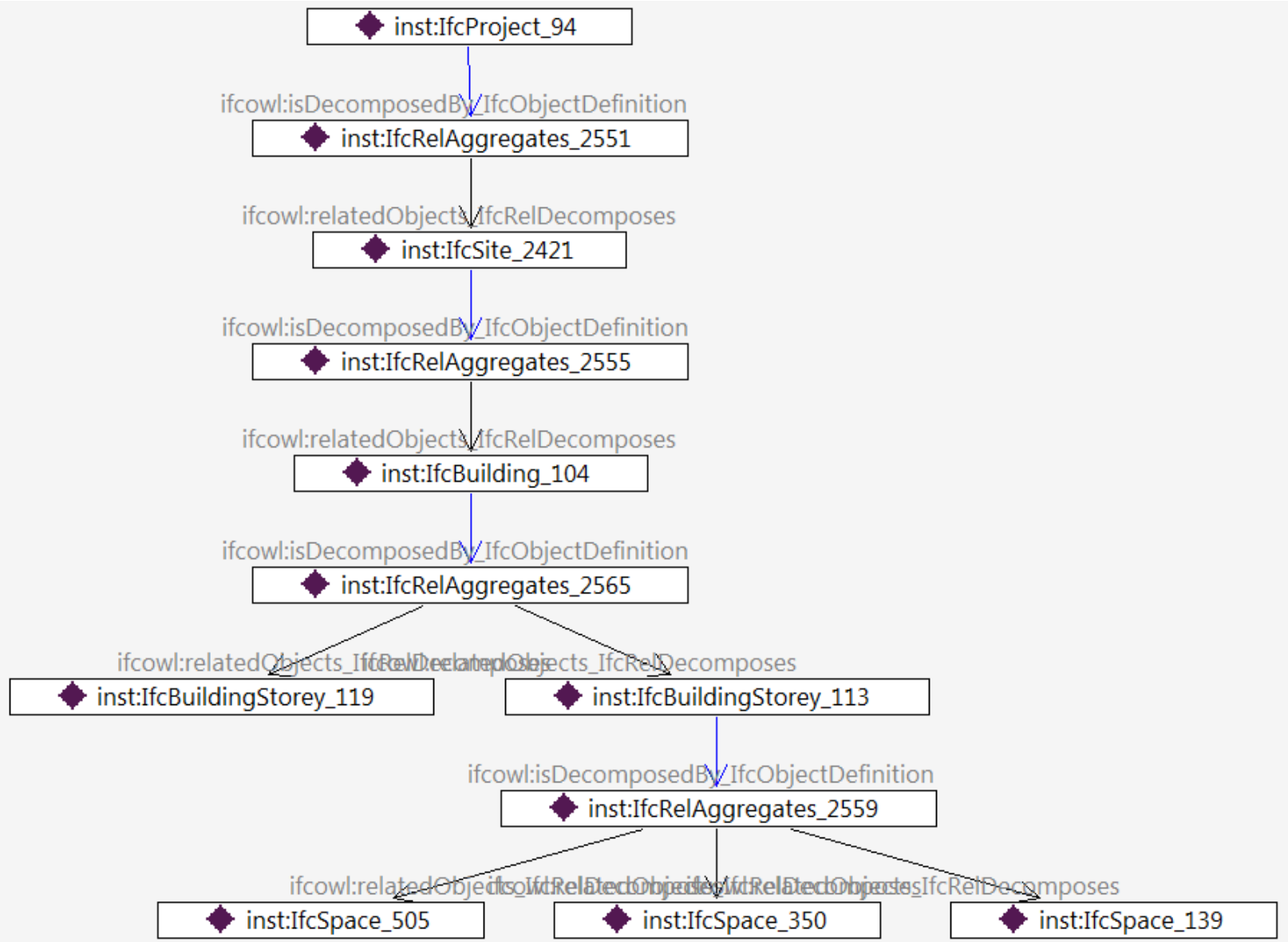

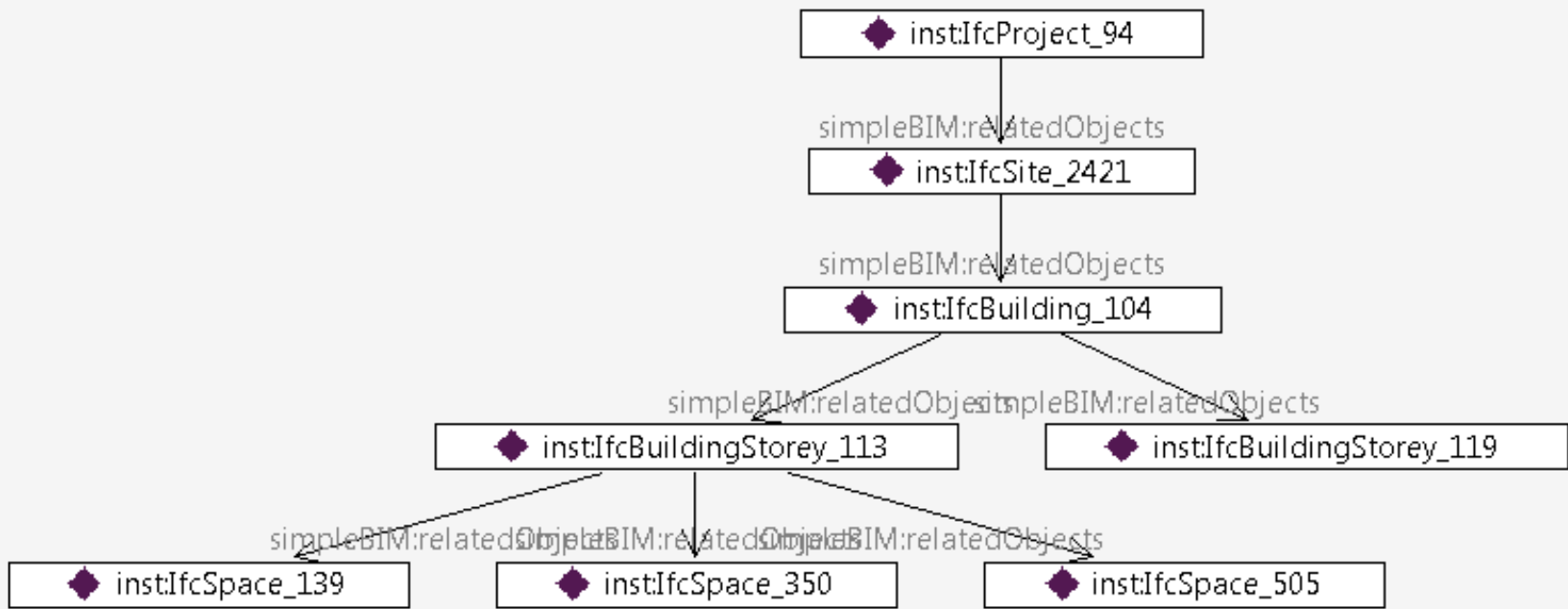

◆ inst:IfcBuilding\_104

ifcowl:globalId\_IfcRoot

◆ inst:IfcGloballyUniqueId\_1719

■ express:hasString = 3dW\$chZ2P2nBViVyUAoH...

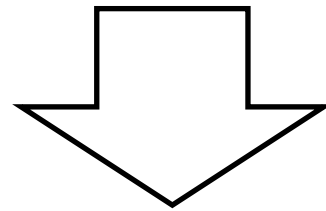

◆ inst:IfcBuilding\_104

■ simpleBIM:globalId = 3dW\$chZ2P2nBViVyUAoH...

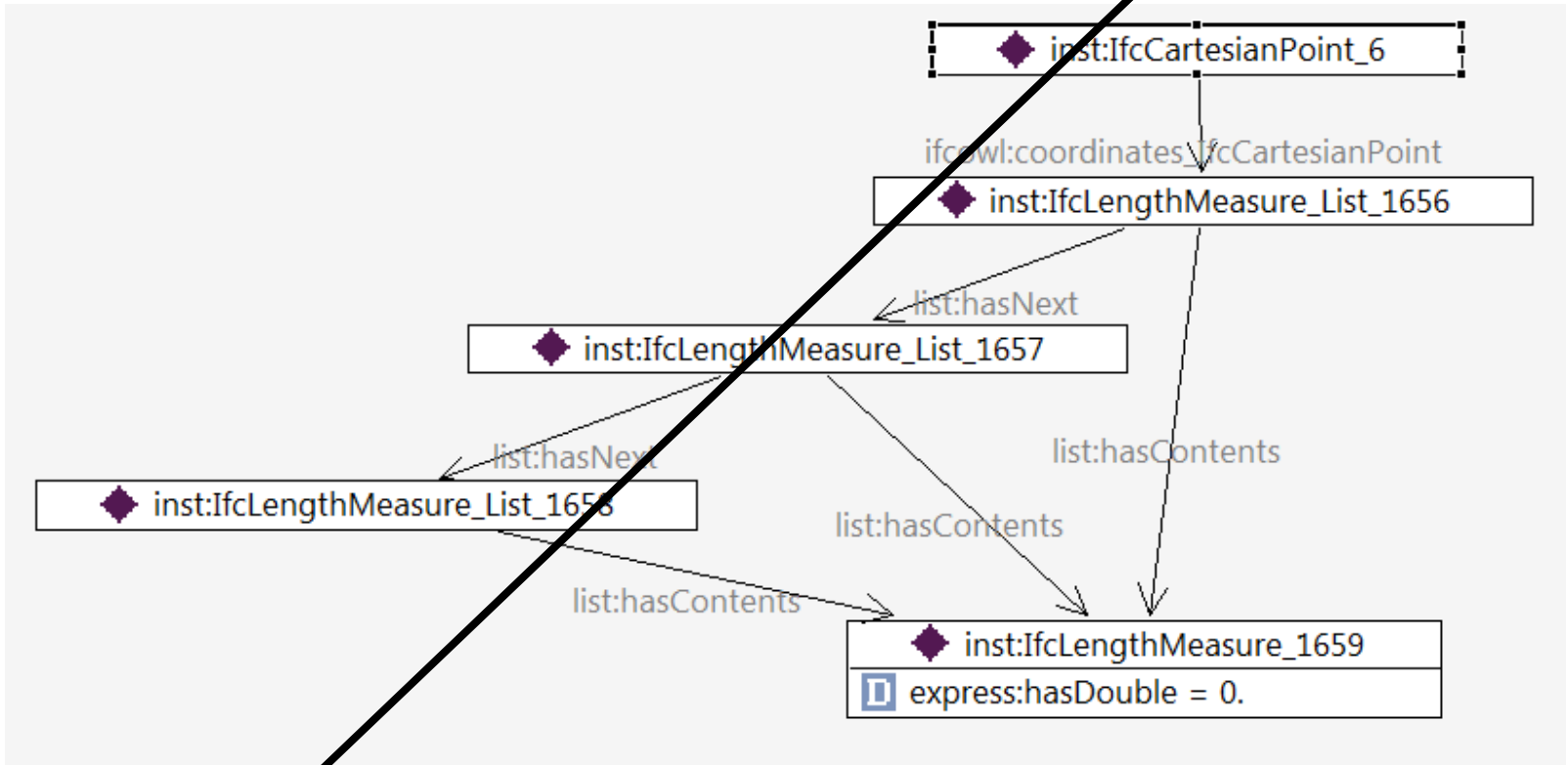

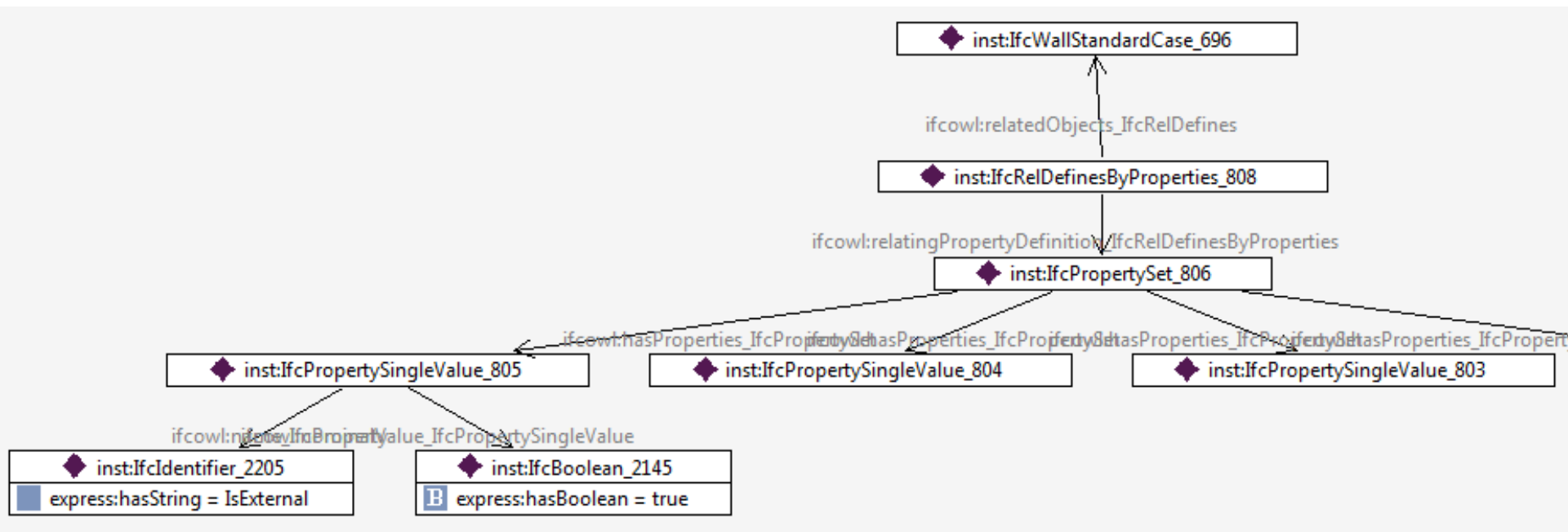

◆ inst:IfcWallStandardCase\_696

- simpleBIM:Area = 81.45110000000001
- simpleBIM:Base\_Constraint = Level: Level 1
- simpleBIM:Base\_Extension\_Distance = 0.
- simpleBIM:Base\_Offset = 0.
- simpleBIM:Base\_is\_Attached = false
- simpleBIM:Category = Walls
- simpleBIM:Enable\_Analytical\_Model = false
- simpleBIM:ExtendToStructure = false
- simpleBIM:Family = Basic Wall: Generic ...
- simpleBIM:Family\_and\_Type = Basic Wall: Generic ...
- simpleBIM:IsExternal = true
- simpleBIM:Length = 21000.
- simpleBIM:LoadBearing = false
- simpleBIM:Location\_Line = Wall Centerline
- simpleBIM:Phase\_Created = New Construction
- simpleBIM:Reference = Generic - 200mm
- simpleBIM:Related\_to\_Mass = false
- simpleBIM:Room\_Bounding = true
- simpleBIM:Structural = false
- simpleBIM:Structural\_Usage = Non-bearing



<b>Model</b>	<b>ifcOWL</b>	<b>ifcOWL</b>	<b>simpleBIM</b>	<b>simpleBIM</b>
1	767kb	10,173 triples	1,339 triples	83kb
2	16,7 MB	225,135 triples	16,836 triples	1.029kb

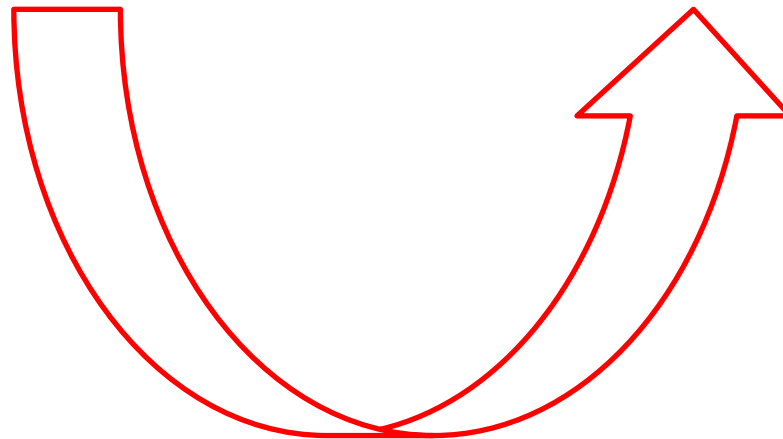

**REDUCTION TO  
8,5% file size  
10,3% triple count**



Converter?  
Rules?  
...?

ifcOWL

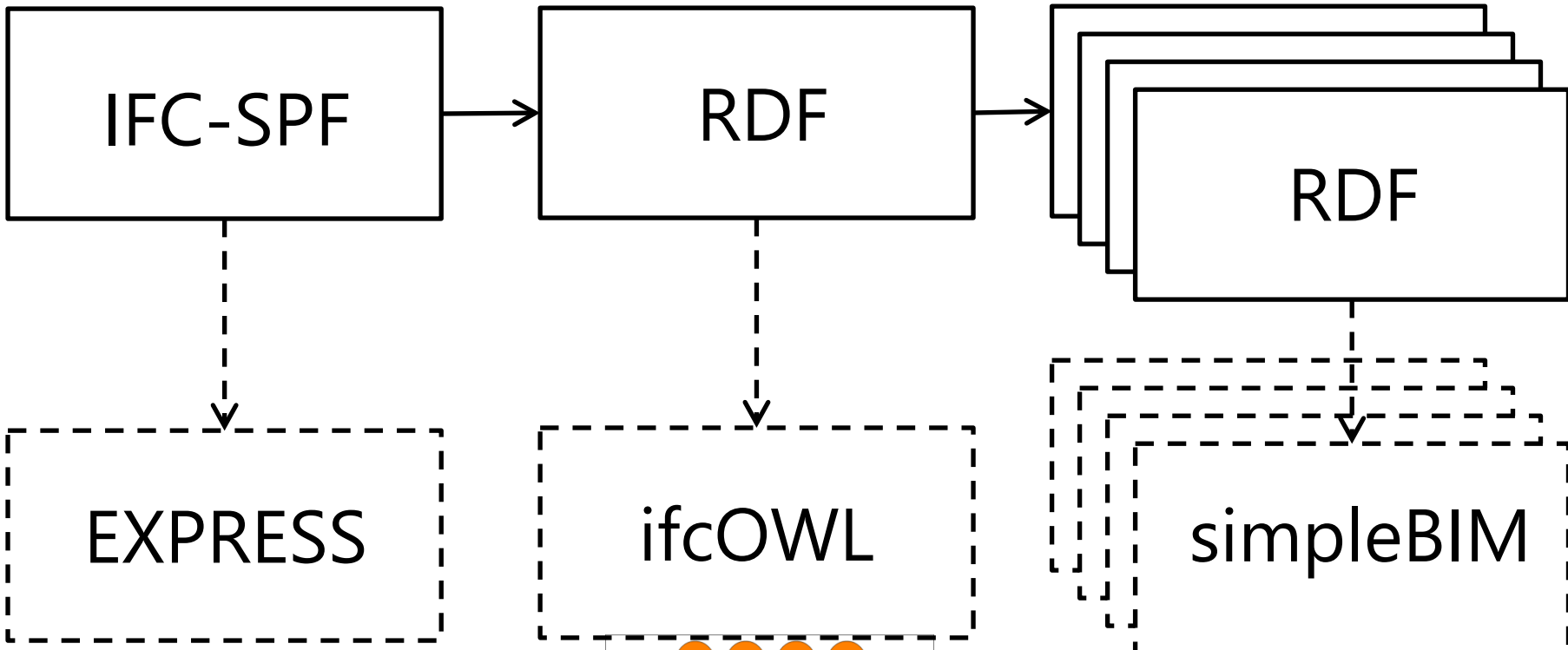

Converter?  
Rules?  
...?

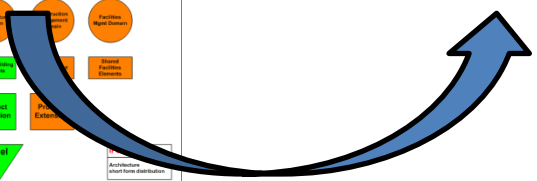
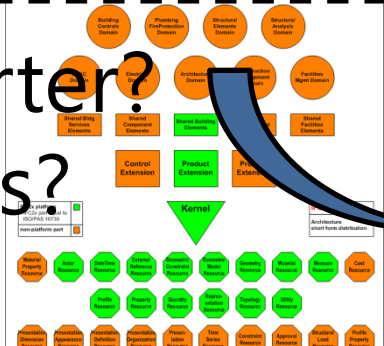

# Thank you

Pieter Pauwels, Ghent University

[pipauwel.pauwels@ugent.be](mailto:pipauwel.pauwels@ugent.be)

LDWG

 building**SMART**<sup>®</sup>  
International home of openBIM